

Versi.

a versatile privacy screen + bracket series



WORKSPACE 

Versi Statement of Line

Screen Styles

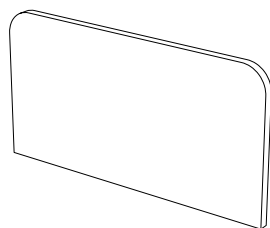

Linear

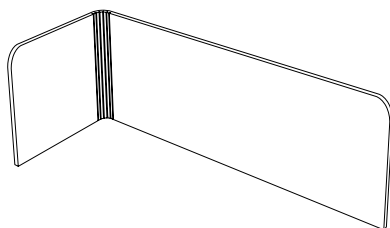

L-Shape

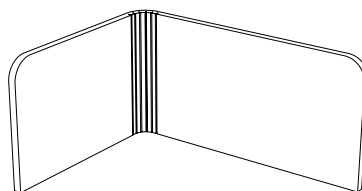

Half Desk

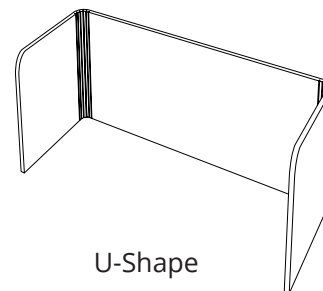

U-Shape

Bracket Options

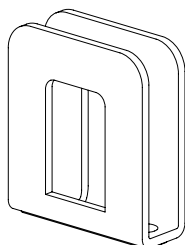

Surface Mount

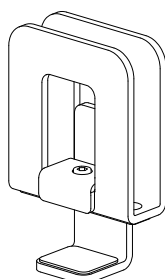

Surface Mount
with Clamp

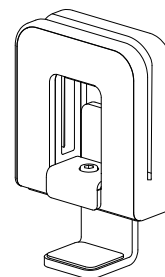

Surface Mount with Clamp
for Glass Screens

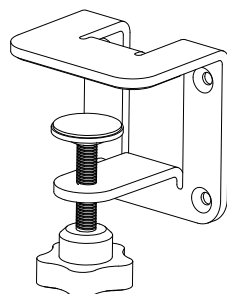

Clamp Mount

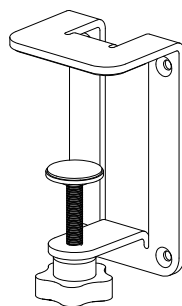

Clamp Mount
with Extra Depth

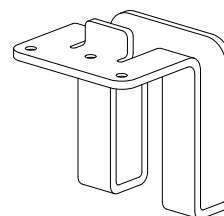

Slip Mount

Versi Screen Styles

Shown with Surface Mount bracket



U-Shape



L-Shape



Linear



Half Desk

Versi Specifications

Applications	Linear, Half Desk, L-Shape and U-Shape
Bracket Compliance	BIFMA X5.6-2016
Composition	100% Polyester (min. 50% recycled PET fiber)
Density	3kg/m2
Environmental	Oeko-Tex Standard 100 certified, VOC free
Half Desk Standard Widths	48", 60", 72" (MARCUS CHECKING ON 72")
Mounting Options	Brackets
Recyclability	100% Recyclable
Sound Absorption	NRC Value .85
Standard Heights	12", 18", 24" ((and 28" (CONFIRM W/ MARCUS?))
Standard Widths	23", 28", 30", 36", 44", 46", 50", 52", 56", 58", 62", 64", 68", 70"
Thickness	.7" / 18mm

Versi Features

Multiple screen styles and bracket options

Tackable and sound-absorbing

8 color options in 50% recycled felt

Universal to use with any desk or worksurface

Versi Product Information

Installation Times

10 minutes per workstation, including brackets.

Certifications

Oeko-Tex Standard 100

BIFMA X5.6-2016

Care & Maintenance

Wipe with a damp cloth using water or gentle, non-abrasive cleaner. For guaranteed safety, patch test with diluted cleaner before wiping entire surface. Wipe dry with a clean cloth.

Warranty

10 years

Cleaning

Disinfect using a ratio of 5 tablespoons (1/3 cup) bleach per gallon of water OR 4 teaspoons bleach per quart of water. This solution ratio is consistent with CDC instruction for virus and bacteria control. Do not soak or rub the diluted bleach solution into the 3F material. Instead, spray apply the diluted bleach solution as a mist and let sit for at least 1 minute before wiping off any cleaning solution residue with a damp cloth. For guaranteed safety, patch test diluted bleach solution in an inconspicuous place on the product before applying widely.



Versi Finishes

Screens

**MFIC** Charcoal

**MFAS** Stone

**MFAS** Ash

**MFBB** Natural

**MFCR** Chilli

**MFDB** Ocean

**MFAV** Avocado

**MFBB** Honey

Brackets

**Black**



**Silver**

**White**

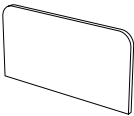
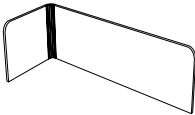
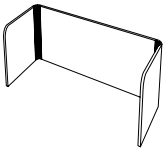
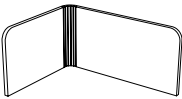

Versi Bracket-Screen Compatibility

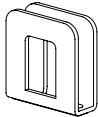
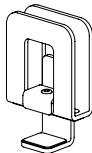
							
		Slip Mount	Surface Mount	Surface Mount with Clamp	Surface Mount with Clamp for Glass	Clamp Mount	Clamp Mount with Extra Depth
	Linear	●	●	●	●	●	●
	L-Shape	●	●	●	●	●	●
	U-Shape	●	●	●	●	●	●
	Half Desk	●	●	●	●	●	●

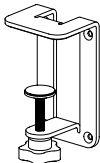
Slip Mount



Features

Underside mounting allows the screens to slip in for easy installation and maintenance.

Creates visual privacy above the worksurface with just enough modesty below the worksurface to hide unsightly cords and cables.

Can be used to mount screens on the side of a 30" deep worksurface or on a 24" deep worksurface if clearance from the cantiliver >1.625".

Leaves 3/4" gap between the screen and the work-surface for wiring, monitor arms, power outlets, etc.

Positioning

A simple and cost-effective solution for privacy screens

When a uniform aesthetic across a floor plan is desired

Applications

Agile Desk or Bench

Axis benching - MARCUS CONFIRM

Any desk or bench

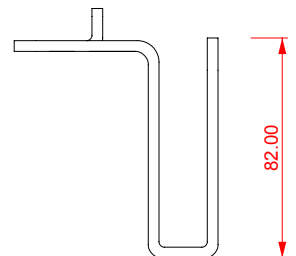
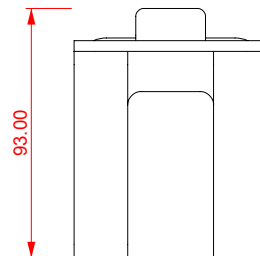
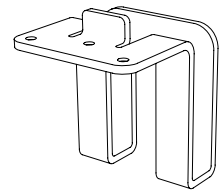
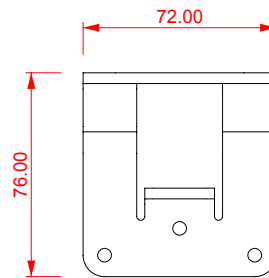

Surface Mount



Features

Mounts directly onto 3 sides of worksurface regardless of cantiliver positioning.

Offers complete visual privacy above the worksurface.

Leaves a 20mm gap under the screen to run wiring to top of worksurface.

Optional clamp attachment avoids mounting into worksurface, preserving its integrity (requires >1.875" clearance from the cantiliver).

Optional corner connector joins linear back and side screens for added structure and complete visual privacy.

Clamp accommodates .75" - 1.75" thick worksurfaces.

Applications

Axis Single Run or Double Run

Axis Single Run or Double run

Back / Side Linear Versi Screens

L-Shape and U-Shape Wrapped Versi Screens

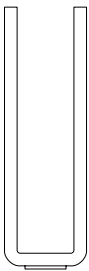
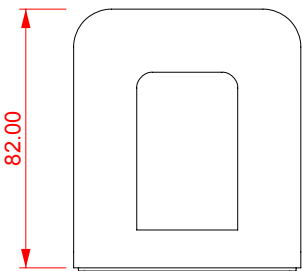
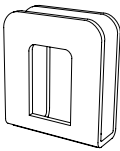
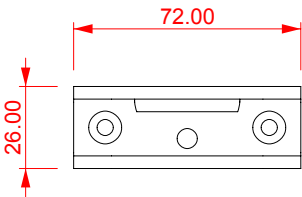

Positioning

For users that desire complete visual privacy on all sides of the worksurface at an accessible price point.

For facility managers that prioritize uniformity across a floor plan and control of individual workstations.

Clamp attachment allows for easy installation without damaging worksurfaces.

Surface Mount with Clamp



Features

Mounts directly onto 3 sides of worksurface regardless of cantiliver positioning.

Offers complete visual privacy above the worksurface.

Leaves a 20mm gap under the screen to run wiring to top of worksurface.

Optional clamp attachment avoids mounting into worksurface, preserving its integrity (requires >1.875" clearance from the cantiliver).

Optional corner connector joins linear back and side screens for added structure and complete visual privacy.

Clamp accommodates .75" - 1.75" thick worksurfaces.

Positioning

For users that desire complete visual privacy on all sides of the worksurface at an accessible price point.

For facility managers that prioritize uniformity across a floor plan and control of individual workstations.

Clamp attachment allows for easy installation without damaging worksurfaces.

Applications

Agile Desks or Benching single and double runs

Axis benching

Any desk or bench

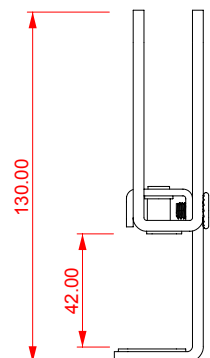
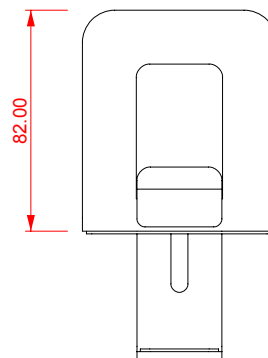
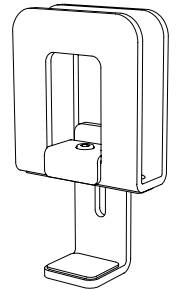
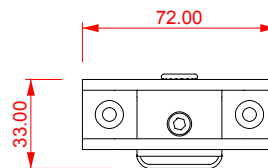

Surface Mount with Clamp for Glass



Features

Mounts directly onto 3 sides of worksurface regardless of cantilever positioning.

Offers complete visual privacy above the worksurface.

Leaves a 20mm gap under the screen to run wiring to top of worksurface.

Optional clamp attachment avoids mounting into worksurface, preserving its integrity (requires >1.875" clearance from the cantilever).

Optional corner connector joins linear back and side screens for added structure and complete visual privacy.

Clamp accommodates .75" - 1.75" thick worksurfaces.

Positioning

For users that desire complete visual privacy on all sides of the worksurface at an accessible price point.

For facility managers that prioritize uniformity across a floor plan and control of individual workstations.

Clamp attachment allows for easy installation without damaging worksurfaces.



Applications

Agile Desks or Benching single and double runs

Axis benching

Any desk or bench using glass screens

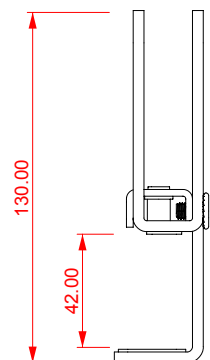
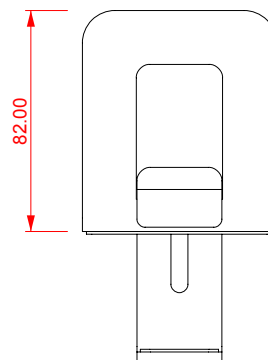
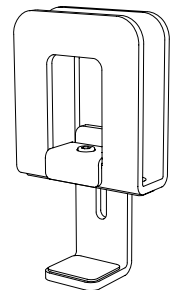
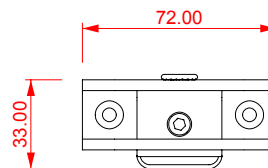

Clamp Mount Bracket



Features

Allows the user to choose the level of privacy both above and below the worksurface at a fixed position.

Bracket can be position anywhere from 3"-7" from the top or bottom of the 3F Screen, providing 15"-19" of privacy or modesty on a 23" screen.

Brackets are not visible from the exterior/aisle side of the workstation.

Can be used to mount screens on the side of a 30" deep worksurface or on a 24" deep worksurface if clearance from the cantiliver >1.5".

Leaves 1" gap between the screen and the worksurface for wiring, monitor arms, power outlets, etc.

Mounting clamp accommodates .5" - 1.7" thick worksurfaces.

Positioning

For users with varying degrees of privacy needs, both above and below the worksurface.

For facility managers who want to customize the level of privacy and modesty provided at each individual workstation.

Applications

Agile Desks or Benching single and double runs

Any desk or bench - is this true?

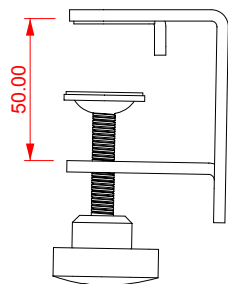
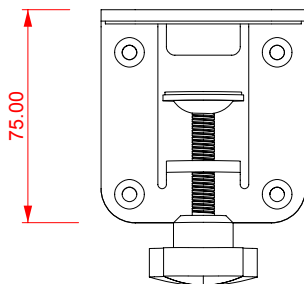
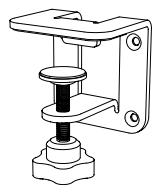
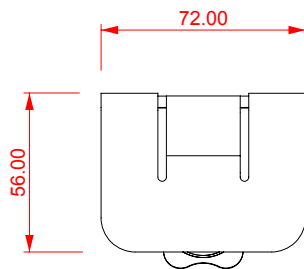

Clamp Mount Bracket with Extra Depth



Features

- Allows the user to choose the level of privacy both above and below the worksurface at a fixed position.
- Bracket can be position anywhere from 3"-7" from the top or bottom of the 3F Screen, providing 15"-19" of privacy or modesty on a 23" screen.
- Brackets are not visible from the exterior/aisle side of the workstation.
- Can be used to mount screens on the side of a 30" deep worksurface or on a 24" deep worksurface if clearance from the cantiliver >1.5".
- Leaves 1" gap between the screen and the worksurface for wiring, monitor arms, power outlets, etc.
- Mounting clamp accommodates .5" - 1.7" thick worksurfaces.

Positioning

- For users with varying degrees of privacy needs, both above and below the worksurface.
- For facility managers who want to customize the level of privacy and modesty provided at each individual workstation.

Applications

- Agile Desks or Benching single and double runs
- Axis benching
- Any desk or bench

